

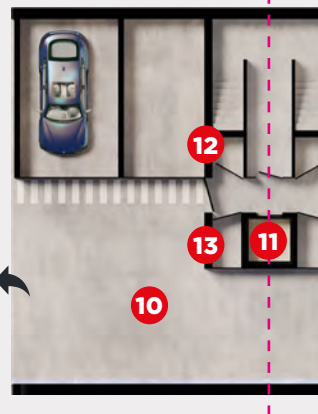

GROUND FLOOR APARTMENTS PINHEIRO

PARKING SPACE



ACCESS
& EXIT

APARTMENT



- 1 Living Room
- 2 Open Kitchen
- 3 Master Bedroom
- 4 Bathroom
- 5 WC with shower
- 6 Studio
- 7 Pool
- 8 Pool Terrace
- 9 BBQ
- 10 Garage
- 11 Elevator
- 12 Storage
- 13 Technical Area

Total Area

122m² (approx.)

The information contained in this document is purely indicative and may be subject to change without prior notice for technical, commercial, or legal reasons.

